

毅達工程顧問有限公司
A-Tech Engineering Consultants Limited

Date: 29th November 2024

Dear Sir / Madam,

Submission of Landscape Proposal

On Lot 168 S.A in D.D. 118

Nam Hang Tsuen, Shap Pat Heung, Yuen Long, N.T.

We would like to submit the attached Landscape Proposal for the captioned for your comments and approval.

For your information, the same proposal was submitted in 2016 which had been approved. Meanwhile, we have enclosed the “acceptable” letter issued by Planning Department with this document as well.

We are looking forward to your reply on the attached proposal. Should you have any queries, please feel free to contact our Project Manager, Mr. Wu at Tel. No. 9607 7207.

Thank you for your kind attention.

Yours faithfully,

For and on behalf of

A-Tech Engineering Consultants Ltd.

For and on behalf of
A-TECH ENGINEERING CONSULTANTS LIMITED
毅達工程顧問有限公司



.....
Authorized Signature(s)



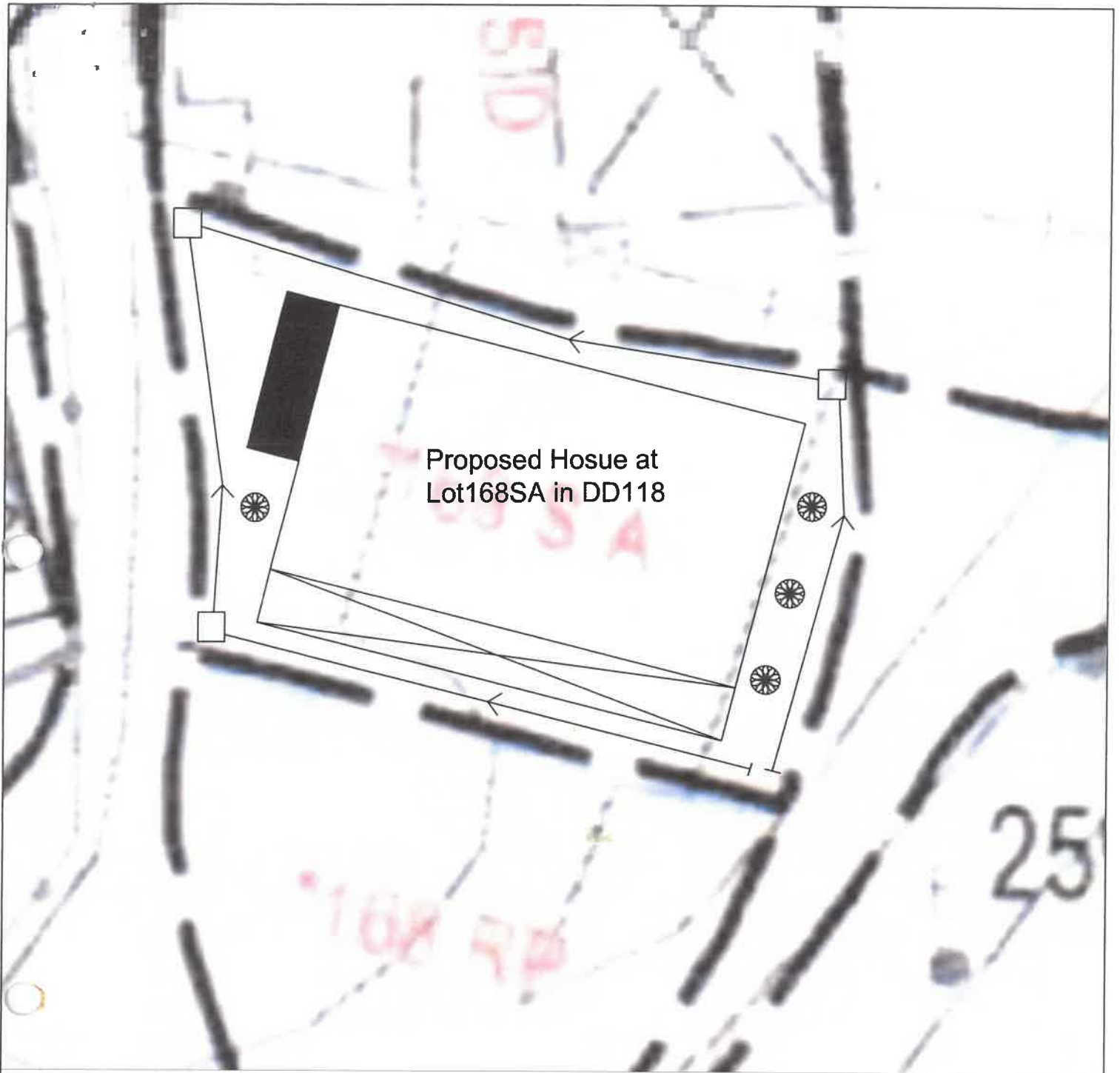

Mr. Wu Wai Ching

Project Manager

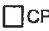

Proposed Hosue at
Lot168SA in DD118

LEGEND

-  CP Proposed CatchPit
-  Proposed 225UC
-  Proposed Septic Tank
(Indicative only, not for approval)
-  Proposed Balcony

 4nos. Bauhinia Purpurea
(2.7m(H), 4m spacing)

Note:

1. The plant to be planted by Open Bottom method, minimum planting soil to be 1.2m.
2. Bamboo staking should be provided to all tree planting.

毅達工程顧問有限公司
A-Tech ENGINEERING
CONSULTANTS LTD.

Title:

Landscape Proposal

DD118-L168A

Drawn by:

DM

Date:

5 Nov 2016

Check by:

DM

Scale:

1:125

Project

**Proposed Houses at Lot 168 S.A. in
D.D.118, Nam Hang Tsuen, Shap Pat
Heung, Yuen Long, N.T. (A/YL-TT/386)**

規 劃 署

屯門及元朗西規劃處
香港新界沙田上禾輦路一號
沙田政府合署 14 樓



By Fax (2478 5787) & Post Planning Department

Tuen Mun and Yuen Long West
District Planning Office
14/F, Sha Tin Government Offices,
1 Sheung Wo Che Road, Sha Tin, N.T.
Hong Kong

來函檔號 Your Reference
本署檔號 Our Reference () in TPB/A/YL-TT/386
電話號碼 Tel. No.: 2158 6298
傳真機號碼 Fax No.: 2489 9711

21 December 2016

A-Tech Engineering Consultants Ltd.
Flat C, 2/F, Fung Yue Building
Kau Yuk Road,
Yuen Long, New Territories
(Attn.: Mr. WU)

種樹接受

Dear Sir/Madam,

Compliance with Approval Condition (b)

Planning Application No. A/YL-TT/386

I refer to your submission dated 5.11.2016 for compliance with the captioned approval condition on the submission and implementation of landscape proposal. The relevant department has been consulted on your submission. Your submission is considered:

- Acceptable. The captioned condition has been complied with. Please find detailed advisory departmental comments at **Appendix**.
- Acceptable. Since the captioned condition requires both the submission and implementation of the proposal, it has not been fully complied with. Please proceed to implement the accepted proposal for full compliance with the approval condition. Please find detailed advisory departmental comments at **Appendix**.
- Not acceptable. The captioned condition has not been complied with.

I regret that due to staff shortage, we are not able to provide you with a translation of the detailed departmental comments. Should you have any queries on the departmental comments, please contact Mr. Marco YIP (Tel: 2231 4348) of our Department or the undersigned.

Yours faithfully,

(Ms. Floria TSANG)
for District Planning Officer/
Tuen Mun and Yuen Long West
Planning Department

C.C.

CTP/UD&L

(Attn.: Mr. Marco YIP)

(Ref: UD A/YL-TT/386 dated
13.12.2016)

Internal

CTP/TPB

APPENDIX

Comments of the Chief Town Planner/ Urban Design & Landscape, Planning Department
(CTP/UD&L, PlanD)

- a. Site photos should be submitted upon implementation of the approved landscape proposal for our consideration.